

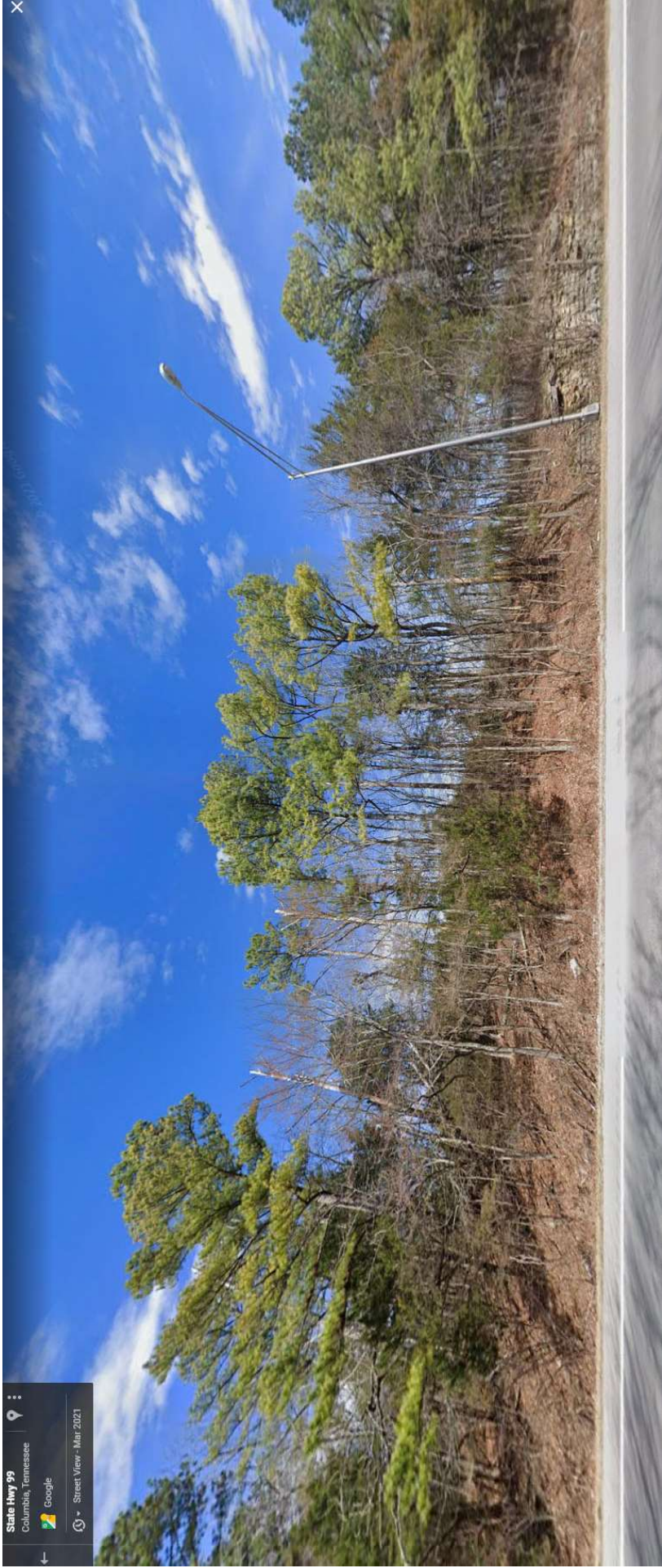

INTERSECTION OF LASEA ROAD AND BEAR CREEK PIKE
(LOOKING NORTH)

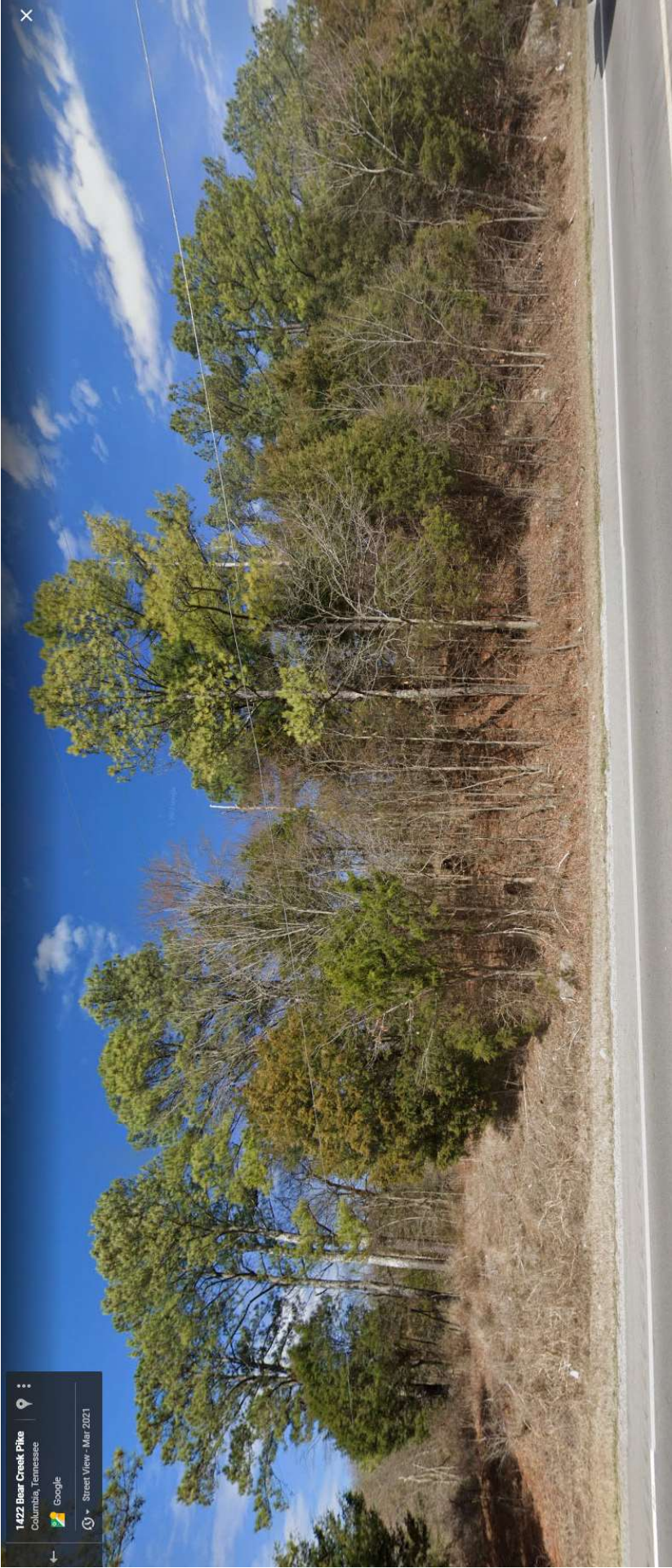

500' WEST OF INTERSECTION OF LASEA ROAD AND BEAR CREEK PIKE
LOOKING NORTH. (TAKEN MARCH 2021)



VIEW FROM ROCK SPRINGS ROAD LOOKING NORTH
PHOTO TAKEN MARCH 2021